

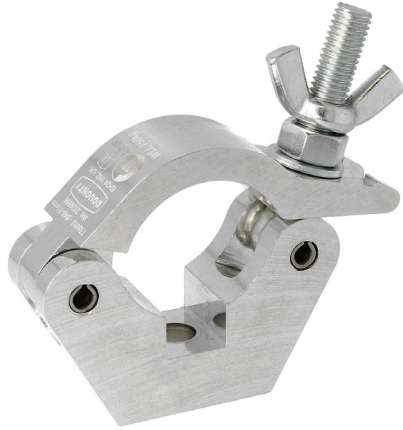

Product Data Sheet

Slimline Half Coupler



A high tensile extruded slimline half coupler Slotted to hold captive an M12 Nut or Bolt	
Part Nos	T57001 - Polished T57011 - Powder Painted Satin Black
Tube Diameter	Ø48 - 51mm
Materials	Main Body - AW6082 T6 Aluminium Roll Pins - Stainless Steel Eyebolt Assy - Grade 8.8
Max Tightening Torque	30Nm
Fixings	To be used with M12 Fixings
WLL	750Kg Vertical Load
Weight	0.41Kg
Factor of Safety	5:1
Approval	TÜV Approved

